



**2 bedroom
Coach House
located in
Colchester.**

£200,000 - £225,000

Find us on..



JOHN ALEXANDER
ESTATE AGENTS

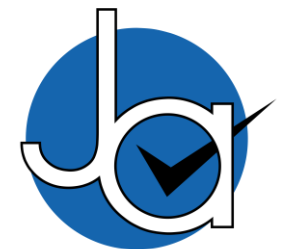

JOHN ALEXANDER
ESTATE AGENTS

30 Memnon Court Colchester CO2 7QW

FULL DESCRIPTION

OVERVIEW

GUIDE PRICE of £200,000 - £225,000

John Alexander present to market this Freehold Coach House home, situated close to the city centre and the Town railway station with its direct links to London Liverpool Street. Property benefits include open plan living, two bedrooms, bathroom and a garage.

ENTRANCE HALL

Stairs rising off to first floor accommodation.

KITCHEN/OPENPLAN LIVING AREA

15' 3" x 11' 4" (4.65m x 3.45m)

LANDING

doors to:

BEDROOM ONE

11' 0" x 9' 4" (3.35m x 2.84m)

BEDROOM TWO

10' 10" x 8' 10" (3.3m x 2.69m)

BATHROOM

6' 10" x 5' 6" (2.08m x 1.68m)

GARAGE



2



1



1



B



EPC

C





JOHN ALEXANDER
ESTATE AGENTS





JOHN ALEXANDER
ESTATE AGENTS

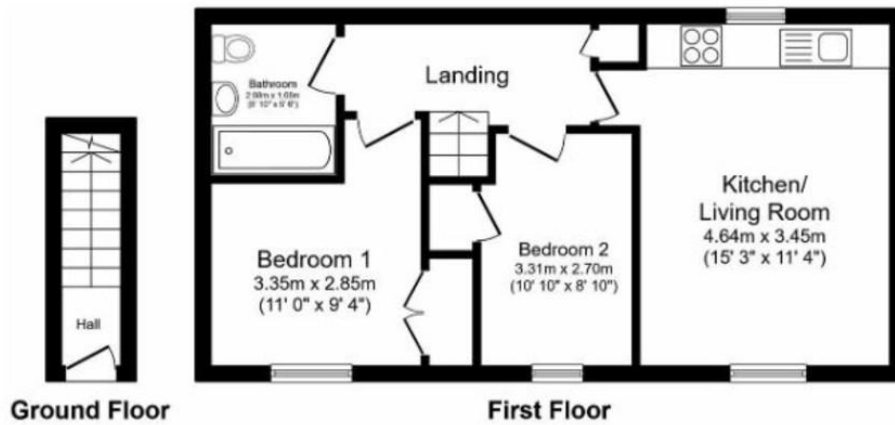

JOHN ALEXANDER
ESTATE AGENTS

FLOORPLAN



Total floor area 45.2 m² (486 sq.ft.) approx

DIRECTIONS

CONTACT

London Road
Stanway
Colchester
Essex
CO3 0NY

E info@john-alexander.co.uk

T 01206 656007

www.john-alexander.co.uk

Find us on..



JOHN ALEXANDER
ESTATE AGENTS