



JOHN ALEXANDER
ESTATE AGENTS



JOHN ALEXANDER
ESTATE AGENTS



JOHN ALEXANDER
ESTATE AGENTS

2 Bedroom Semi-Detached House located in Tiptree.

Find us on..



JOHN ALEXANDER
ESTATE AGENTS

Sage Walk Tiptree Colchester CO5 0AR



2



1



1

FULL DESCRIPTION

OVERVIEW

We're delighted to present this two-bedroom semi-detached property situated at the end of the cul-de-sac, in a sought-after location. The current owner has recently improved the property, including new flooring throughout. Additionally, it features a garage and parking facilities.

ENTRANCE PORCH

LOUNGE/DINER

17' 5" x 13' (5.31m x 3.96m)

KITCHEN

12' 9" x 8' 9" (3.89m x 2.67m)

CONSERVATORY

13' 3" x 7' 6" (4.04m x 2.29m)

LANDING

BEDROOM ONE

13' 2" x 9' 3" (4.01m x 2.82m)

SHOWER ROOM

BEDROOM TWO

13' 2" x 9' 3" (4.01m x 2.82m)

REAR GARDEN

Decking area, with laid to lawn, flower and shrub borders, access to parking and garage.

Asking Price Of £300,000

We're delighted to present this two-bedroom semi-detached property situated at the end of the cul-de-sac, in a sought-after location. The current owner has recently improved the property, including new flooring throughout. Additionally, it features a garage and parking facilities.







Sage Walk, Tiptree CO5 0AR



Sage Walk

Approximate Gross Internal Area = 76.3 sq m / 821 sq ft

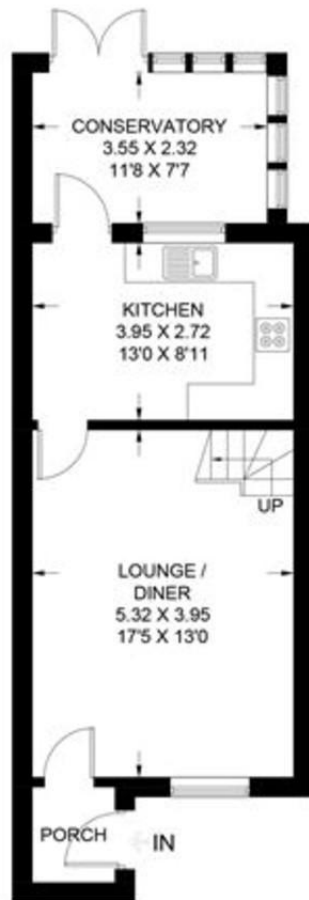

Ground Floor
43.7 sq m / 470 sq ft



First Floor
32.6 sq m / 351 sq ft

Illustration for identification purposes only,
measurements are approximate, not to scale.

CONTACT
1 Church Road
Tiptree
Colchester
Essex
CO5 0LG
E info@john-alexander.co.uk

T 01621 814334 www.john-alexander.co.uk

Find us on..



JOHN ALEXANDER
ESTATE AGENTS