



## 3 bedroom Semi-Detached House located in Harwich.

Guide Price  
£250,000 - £270,000

Find us on..



**JOHN ALEXANDER**  
ESTATE AGENTS



# Main Road Harwich CO12 4LZ

## FULL DESCRIPTION

### THE OVERVIEW

\*\*\*Guide Price Of £250,000 - £270,000\*\*\*

This property featured on the Main Road, includes two reception areas-a lounge and a dining room, a recently renovated and refurbished kitchen, as well as a convenient downstairs shower room. It offers three bedrooms, one of which is slightly smaller, along with an upstairs family bathroom. Additionally, the property benefits from a driveway & off-road parking and a garden that is currently undergoing development.

### THE HOME

Upon entering the home, you are greeted by the welcoming entrance hallway that seamlessly connects to all the ground floor rooms. The property features a charming living room filled with natural light, a spacious separate dining area perfect for gatherings, and a stylish, fully refurbished kitchen with doors that open out to the garden-ideal for outdoor entertaining and relaxation. Additionally, there is a convenient downstairs shower room, offering extra practicality and comfort.

Upstairs, the property offers three bedrooms, with one being slightly smaller and more box-shaped-making it perfect for a variety of uses such as a home office, children's playroom, or additional storage space. Additionally, there is a family bathroom to complete the upstairs layout.

### THE OUTSIDE

The exterior includes a driveway providing off-road parking, along with a garden that is currently undergoing renovations.

### THE LOCATION

The property boasts a prime location on the main road, ideally positioned just moments from a variety of local amenities and reputable schools, offering both convenience and accessibility.



3



2



2



EPC

E





## FLOORPLAN

GROUND FLOOR

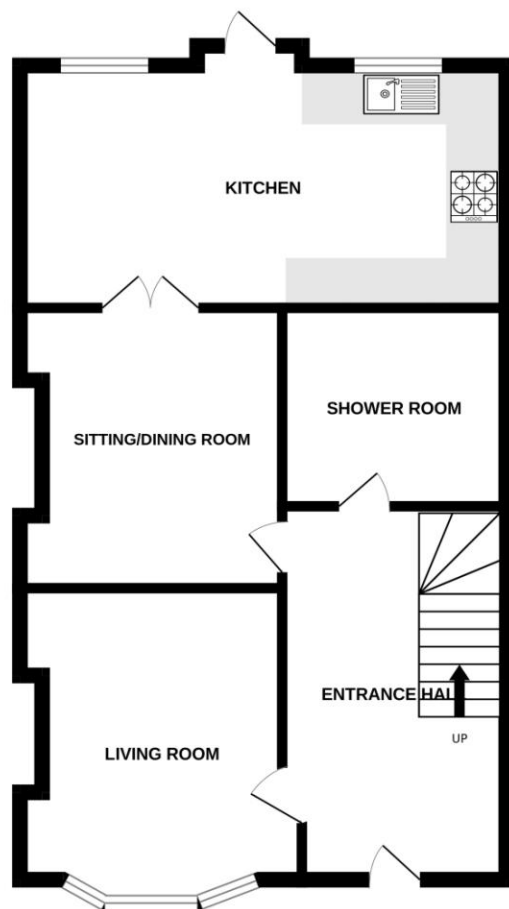

1ST FLOOR

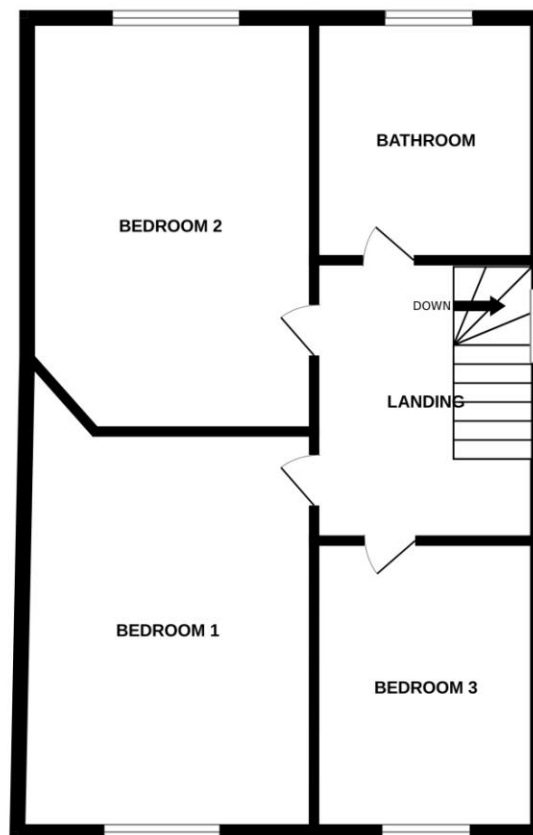

Whilst every attempt has been made to ensure the accuracy of the floorplan contained here, measurements of doors, windows, rooms and any other items are approximate and no responsibility is taken for any error, omission or mis-statement. This plan is for illustrative purposes only and should be used as such by any prospective purchaser. The services, systems and appliances shown have not been tested and no guarantee as to their operability or efficiency can be given.  
Made with Metropix ©2025

## DIRECTIONS

### CONTACT

**288 High Street  
Harwich  
Essex  
CO12 3PD**

**E [enquiries@john-alexander.co.uk](mailto:enquiries@john-alexander.co.uk)**

**T 01255 520007**

**[www.john-alexander.co.uk](http://www.john-alexander.co.uk)**

Find us on..

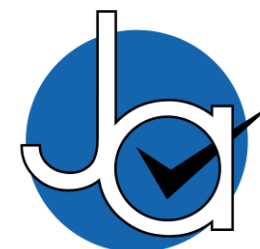

**JOHN ALEXANDER**  
**ESTATE AGENTS**